



Facilities Engineering and Design Services for Industrial Applications

MANUFACTURING PLANTS | LIFE SCIENCES | HIGH-TECH | CLEAN FACILITIES |
CONSUMER PRODUCTS | FOOD AND CHEMICAL

Industrial Applications: Full-Service Design Engineering and Specialty Capabilities

Building, renovating, and managing industrial facilities require commitment to performance, schedule, sustainability, and energy efficiency. Erdman Anthony has over 60 years of multidisciplinary design experience. Our engineers understand the demands and coordination required to navigate complex industrial processes and integrate them into buildings to bring research and production facilities to life.



Industrial and Manufacturing Facilities Served

- Heavy, Medium, and Light Manufacturing Plants
- Clean Environments
- Current Good Manufacturing Practices (cGMP)
- High-Tech, Laboratory, Close Tolerance Manufacturing
- Precision Optics
- Food Processing
- Chemical Process
- Life Sciences/Pharmaceutical
- Medical Devices
- Oil and Gas Industry
- Printing and Paper
- Automotive
- Film and Plastics
- Consumer Products
- Energy and Power



BIM and Laser Scanning Proficiency: Tools for Industrial Facilities

Erdman Anthony uses the latest industry tools to design, analyze, and simulate new or existing buildings, saving time and money in visualizing, planning, and designing plant modifications and upgrades. We do this using the following data-collection and management tools, plus information-rich models:

- **Laser scanning** captures existing building conditions using laser scanning technology to create highly accurate 3D computer models—suitable for further engineering, procurement, construction, and facilities management.
- **Building information modeling (BIM)** adds associated documents or output reports to the created data in the 3D model, combining graphical and nongraphical data to be used to access specific information from the design.

Laser scanning and BIM advantages for facilities' users, builders, and designers include improved accuracy, safety, communication, and savings in time, money, and energy.



Erdman Anthony is a full-service engineering firm that offers:

- Mechanical, Electrical, and Plumbing (MEP) Engineering
- Refrigeration Engineering
- Infrastructure Engineering
- Structural Engineering
- Surveying, GIS, Laser Scanning, and BIM
- Energy Consulting
- Commissioning (New and Existing Buildings)
- Fire Protection and Life Safety Services

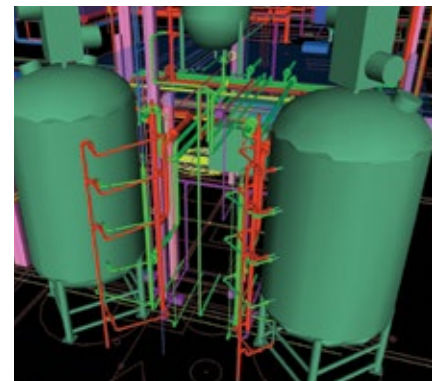
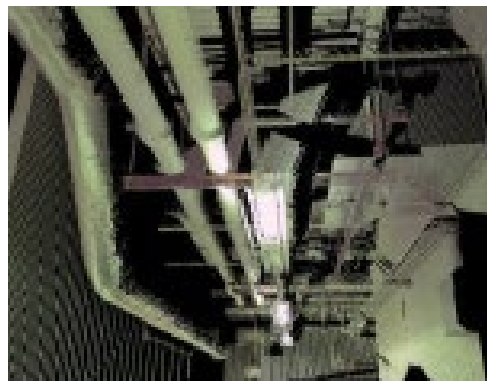

Erdman Anthony is Experienced with Facilities' Support Systems

- Central Heating and Cooling
- Power and CoGen Plants
- Refrigeration Systems (CO₂, Ammonia, Secondary Coolant Refrigerants)
- High-Purity Water and Wastewater Treatment
- Bio-Hazard Containment, Bag-In/Bag-Out Filtration
- Dust Collection and Industrial Ventilation
- Material Handling, Mechanical and Pneumatic Conveying
- Mini-Environments/Environmental Control Chambers/Cleanrooms
- Specialty and Hazardous Exhaust Systems
- Industrial Gases and Compressed Air
- Hazardous Material Storage, Classification, and Facility Design
- Arc Flash and Coordination Studies
- High- and Medium-Voltage Power Systems, Substations and Transmission
- Building Management and Control Systems (BMS)
- Metering, Supervisory Control and Data Acquisition (SCADA), and Historical Data Collection

NYSERDA's Industrial and Process Efficiency Program

Our engineers are experienced with retrocommissioning and carrying out projects within the scope of NYSERDA's performance-based incentives. NYSERDA's IPE Program helps manufacturers and data centers implement energy efficiency and process improvements that will improve productivity and reduce costs.

Take advantage of this money-saving process with SustainabiliTEAM™, Erdman Anthony's approach to sustainable design and building operation, which combines the efforts of our engineers, energy analysts, and commissioning professionals.



Get proven industrial and process support experience from Erdman Anthony.

Since 1954, we've been dedicated to developing superior infrastructure solutions by partnering with our clients, studying their unique situations, and listening carefully to their needs.

Members



Accreditations



Our quality management system is certified to the ISO 9001:2015 standard.

Erdman Anthony's industrial clients include:

- Oberthur Technologies
- American Beverage Corporation
- Crystal IS
- Xerox Corporation
- Eastman Kodak Company
- Rochester Precision Optics
- Wyeth Pharmaceutical
- Sentry Group

To learn more about our firm, visit:

www.erdmananthony.com/Industrial

For more information, contact:

Jeffrey C. Bidell, PE, CBCP, LEED® Green Associate™

Mechanical Engineering Department Manager

(585) 427-8888, ext. 1062

BidellJ@erdmananthony.com

Corporate Headquarters:

145 Culver Road, Suite 200 • Rochester, NY 14620

(585) 427-8888

ERDMAN ANTHONY 
erdmananthony.com

NY: ALBANY | BUFFALO | ROCHESTER

PA: HARRISBURG | PITTSBURGH

FL: WEST PALM BEACH ME: PORTLAND